

Package Outline Dimensions

V-DFN3020-13/SWP (Type A1)

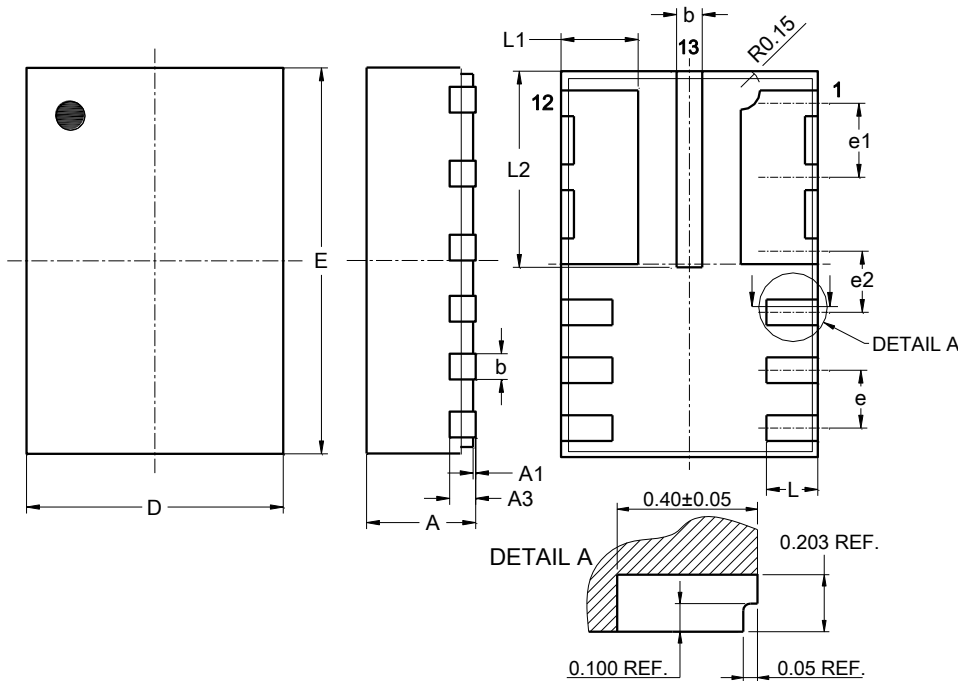

V-DFN3020-13 /SWP (Type A1)			
Dim	Min	Max	Typ
A	0.80	0.90	0.85
A1	0.00	0.05	0.02
A3	0.203REF		
b	0.15	0.25	0.20
D	2.00BSC		
E	3.00BSC		
e	0.45 BSC		
e1	0.575 BSC		
e2	0.475 BSC		
L	0.35	0.45	0.40
L1	0.55	0.65	0.60
L2	1.475	1.575	1.525
All Dimensions in mm			

Suggested Pad Layout

V-DFN3020-13/SWP (Type A1)

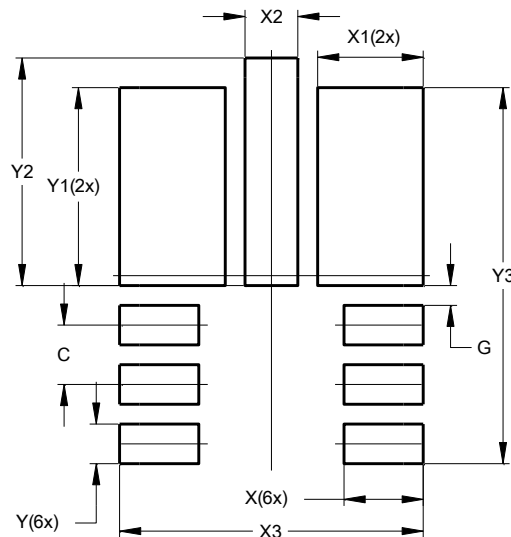

Dimensions	Value (in mm)
C	0.45
G	0.175
X	0.60
X1	0.80
X2	0.30
X3	2.30
Y	0.30
Y1	1.450
Y2	1.725
Y3	2.825

ALL DIMENSIONS ARE NOMINAL VALUES SHOWN IN MILLIMETERS

Note: The suggested land pattern dimensions have been provided for reference only, as actual pad layouts may vary depending on application. These numbers may be modified based on user equipment capability or fabrication criteria. A more robust pattern may be desired for wave soldering and is calculated by adding 0.2 mm to the 'Z' dimension. For further information, please reference document IPC-7351A, Naming Convention for Standard SMT Land Patterns, and for International grid details, please see document IEC, Publication 97.