

Package Outline Dimensions

U-DFN1006-3/SWP (Type UX)

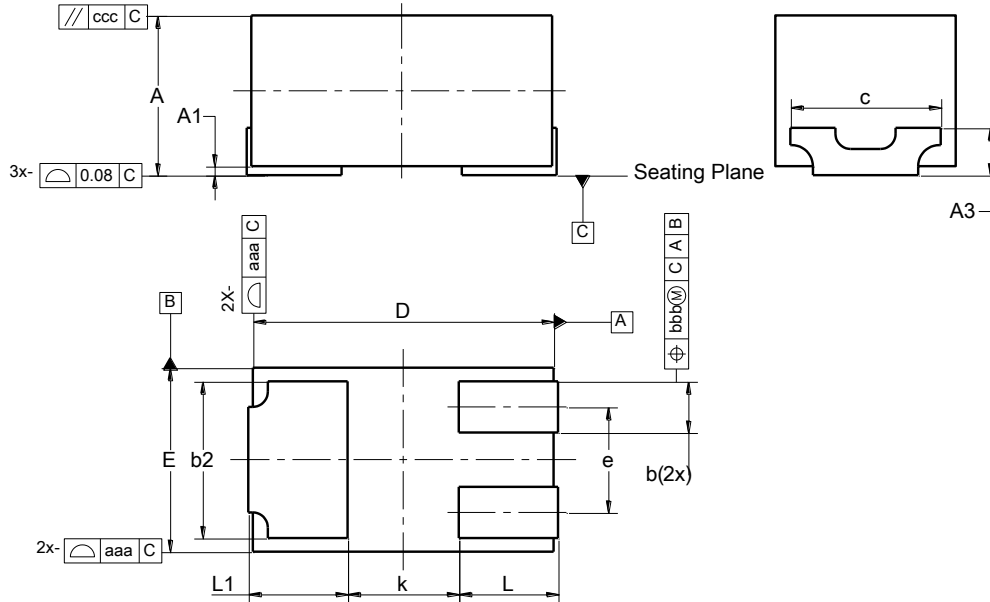

U-DFN1006-3/SWP (Type UX)			
Dim	Min	Max	Typ
A	0.47	0.53	0.50
A1	0.00	0.05	0.03
A3	0.17 REF		
b	0.12	0.22	0.17
b2	0.47	0.57	0.52
D	0.95	1.05	1.00
E	0.55	0.65	0.60
e	--	--	0.35
k	0.37 REF		
L	0.28	0.38	0.33
L1	0.28	0.38	0.33
c	0.50 REF		
aaa	0.15		
bbb	0.05		
ccc	0.05		
All Dimensions in mm			

Suggested Pad Layout

U-DFN1006-3/SWP (Type UX)

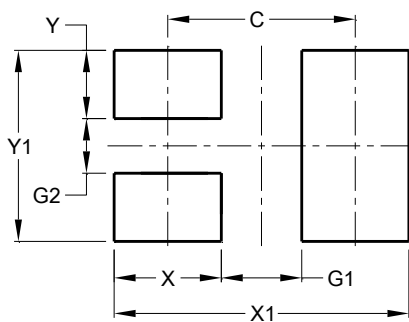

Dimensions	Value (in mm)
C	0.700
G	0.300
G1	0.200
X	0.400
X1	1.100
Y	0.250
Y1	0.700

ALL DIMENSIONS ARE NOMINAL VALUES SHOWN IN MILLIMETERS

Note: The suggested land pattern dimensions have been provided for reference only, as actual pad layouts may vary depending on application. These numbers may be modified based on user equipment capability or fabrication criteria. A more robust pattern may be desired for wave soldering and is calculated by adding 0.2 mm to the 'Z' dimension. For further information, please reference document IPC-7351A, Naming Convention for Standard SMT Land Patterns, and for International grid details, please see document IEC, Publication 97.