

Package Outline Dimensions

TO220AC (Type HE)

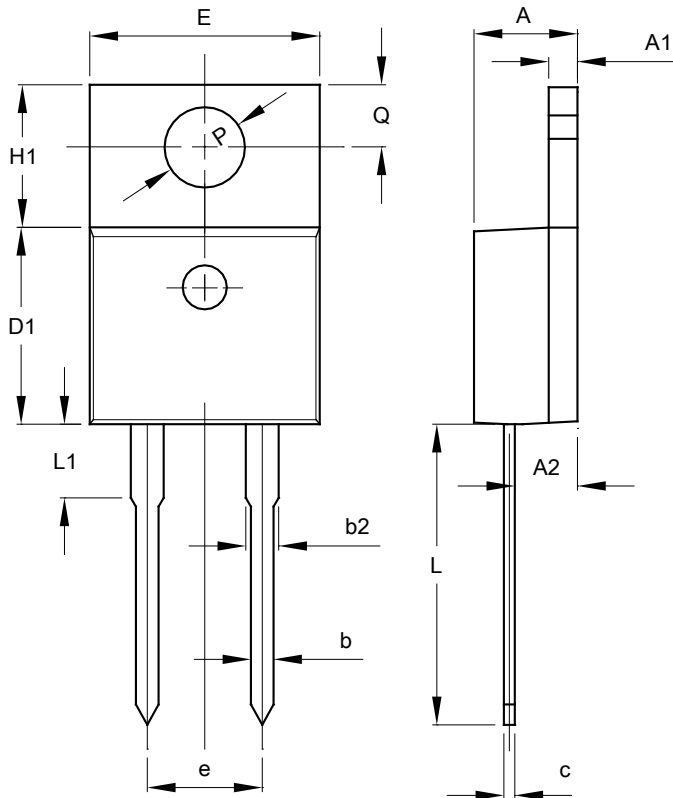

TO220AC (Type HE)			
Dim	Min	Max	Typ
A	4.37	4.77	4.57
A1	1.22	1.42	1.27
A2	2.49	2.89	2.69
b	0.76	0.91	0.81
b2	1.17	1.47	1.27
c	0.30	0.48	0.38
D1	8.50	8.90	8.70
e	5.08 BSC		
E	9.86	10.36	10.16
H1	6.10	6.50	6.30
L	13.10	13.70	13.40
L1	--	4.10	3.75
PØ	3.70	3.99	3.84
Q	2.54	2.94	2.74
All Dimensions in mm			