

SYMBOLS	MIN.	NOM.	MAX.
A	0.80	0.85	0.90
A1	0.00	0.02	0.05
A3	0.203 REF.		
b	0.15	0.20	0.25
D	4.90	5.00	5.10
E	4.90	5.00	5.10
e	0.40 BSC		
L	0.35	0.40	0.45
L1	0.33	0.38	0.43
D2	3.40	3.50	3.60
E2	3.40	3.50	3.60

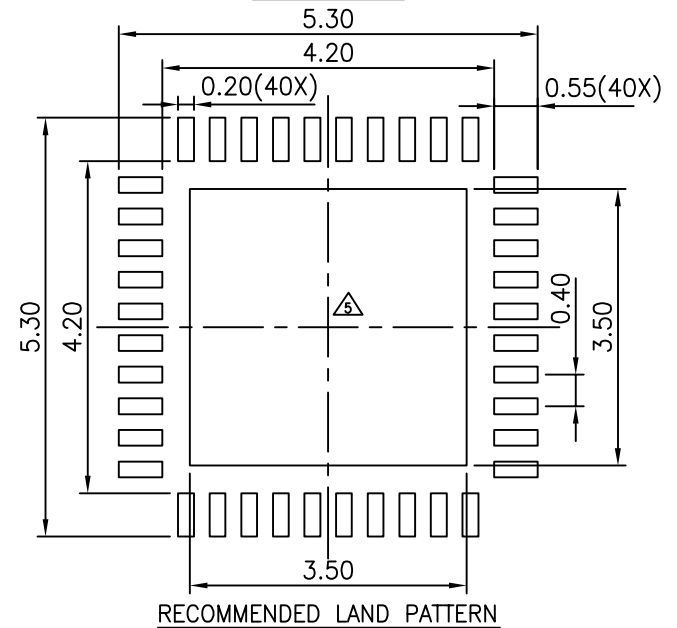

NOTE :

1. ALL DIMENSIONS ARE IN mm. ANGLES IN DEGREES.
2. COPLANARITY APPLIES TO THE EXPOSED THERMAL PAD AS WELL AS THE TERMINALS.
3. REFER JEDEC MO-220
4. RECOMMENDED LAND PATTERN IS FOR REFERENCE ONLY.
5. THERMAL PAD SOLDERING AREA (MESH STENCIL DESIGN IS RECOMMENDED).

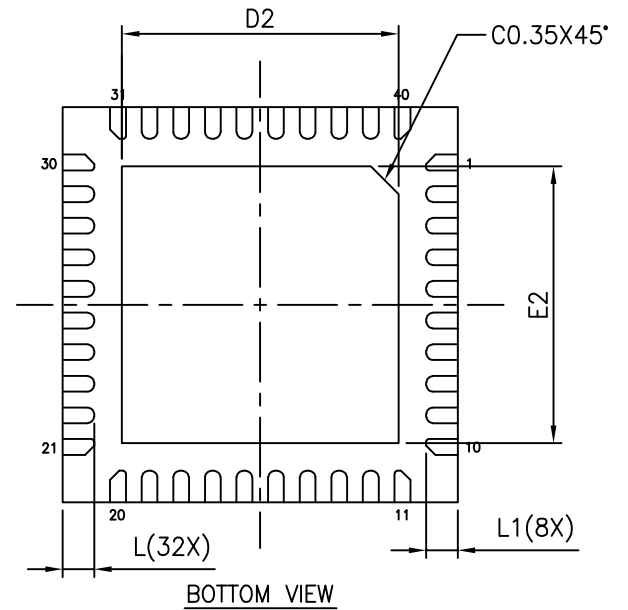
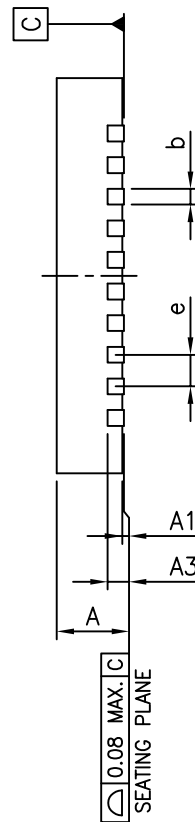

DATE: 05/09/23

DESCRIPTION: V-QFN5050-40

PACKAGE CODE: ZLF (ZLF40)

DOCUMENT CONTROL #: PD-2284

REVISION: --